

DDR-II (BL605Mini)(EV4N1) - Assembly Instructions

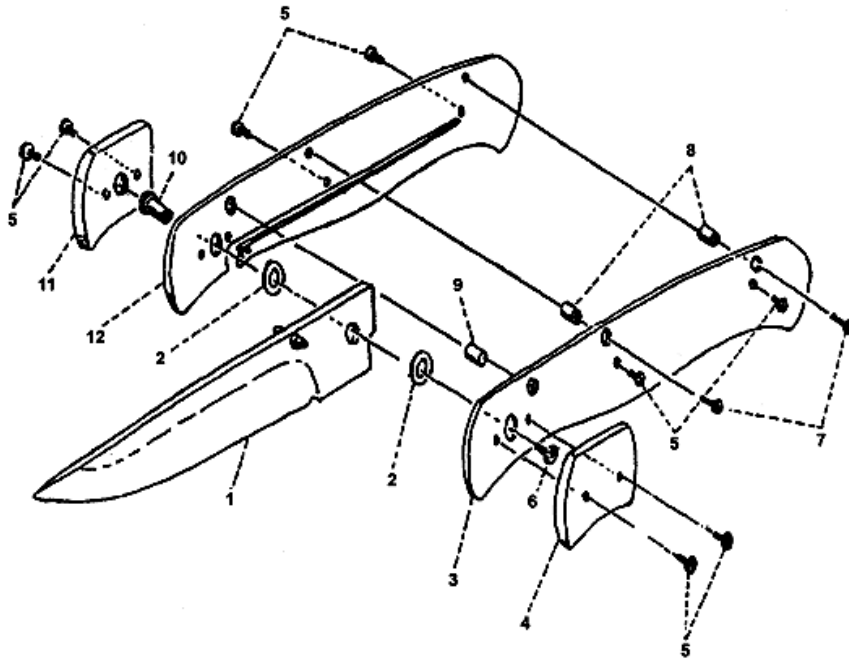

ASSEMBLY INSTRUCTIONS:

(Caution-Blade is Sharp)

PARTS LIST

- | | |
|--|-------------------------|
| 1) Blade | 7) (2) Flat head screws |
| 2) White Teflon washers (2) | 8) (2) Standoffs |
| 3) Left liner | 9) Blade stop pin |
| 4) Left bolster | 10) Pivot pin |
| 5) (8) Short round head screws | 11) Right bolster |
| 6) Pivot pin screw (uses T8 torx driver) | 12) Right liner |

Note: With the exception of the pivot pin screw (1), all screws use a size T6 torx driver. Pivot pin screw uses size T9 driver.

- Insert blade stop pin (9) into hole in the right liner (12) as shown in diagram.
- Rotate pivot pin (10) so flat area aligns with flat spot in right bolster/liner hole, and insert as shown
- Place white teflon washer (2) over pin (10) on inside of right liner. Then fix blade (1) on to pivot pin in open position.
- Note: The back end of blade should rest against stop pin (11).
- Place white Teflon washer (2) over end of pin (10).
- Align holes in left liner (3) over end of pin (10).
- Align standoffs (8) over holes between liners.
- Insert flathead screws (7) and thread-in lightly.
- Close blade and check alignment. Adjust by slightly flexing liners. If necessary, tighten screws firmly.
- Attach handle scales of your choice or those provided in the upgrade kit with remaining short screws.
- Using two short round head screws (5) attach left bolster (4) to left liner (3). Repeat procedure for right bolster (11) and right liner (12).